

BATHROOM FURNITURE, VANITY UNIT FOR WASHBASIN, SINK VANITIES,  
BATHROOM FURNITURE WITH LIGHTING LEVANTO

---

PRODUCT INFORMATION

---



Model	B149UL
Width	47 1/4" inch
Height	21 5/8" inch
Depth	19 5/8" inch
Weight	145,5 lbs
Description	<p>Wood            Cannot be combined with 8" spread faucets            Fastening set            centered washbasin            with dimmable LED mood lighting            Equipped with: 4 pull-out compartments, 4 accessory boxes, 2 large glass drawer dividers, 4 small glass drawer dividers            Handles: 2 - Handle Version 2            For combination with: surface-mounted washbasins Memento 5133 U3/UJ, 5133 U5/UL            Front: Macassar Décor or Glossy Walnut (particle board, melaminated), Glossy White (MDF, vinylated)            Corpus: Macassar Décor or Glossy Walnut (particle board, melaminated), Glossy White (MDF, vinylated)            Drawers: fitted with Soft Closing feature            CARB Compliant materials (ATCM 93120_93120.12 Title 17)            CARB P2, UL listed            soft closing drawer slides            fully assembled            C002 U3 00</p>
Installation	Wall-mounted
Material	Wood
Specification texts	<p>; Vanity Unit; Wood; Size: 47 1/4" x 21 5/8" x 19 5/8" (1200 x 550 x 500 mm); Wall-mounted; Cannot be combined with 8" spread faucets; Fastening set; centered washbasin; with dimmable LED mood lighting; Equipped with: 4 pull-out compartments, 4 accessory boxes, 2 large glass drawer dividers, 4 small glass drawer dividers; Handles: 2 - Handle Version 2; For combination with: surface-mounted washbasins Memento 5133 U3/UJ, 5133 U5/UL; Front: Macassar Décor or Glossy Walnut (particle board, melaminated), Glossy White (MDF, vinylated)            Corpus: Macassar Décor or Glossy Walnut (particle board, melaminated), Glossy White (MDF, vinylated)            Drawers: fitted with Soft Closing feature; CARB Compliant materials (ATCM 93120_93120.12 Title 17)            CARB P2, UL listed; soft closing drawer slides; fully assembled;            C002 U3 00</p>

## COLOURS

Glossy White	B149ULDH	4051202366636
Oak Graphite	B149ULFQ	4051202366650
Elm Impreso	B149ULPN	4051202366643

# TECHNICAL DRAWINGS

## B149UL

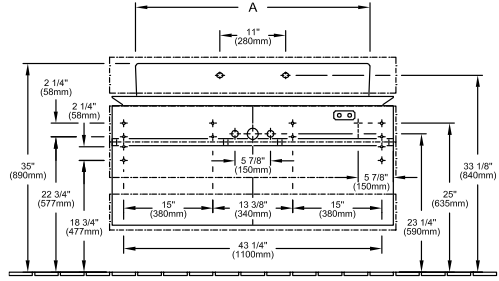

N.L.L. 110 - 120 V mains connectn, loose

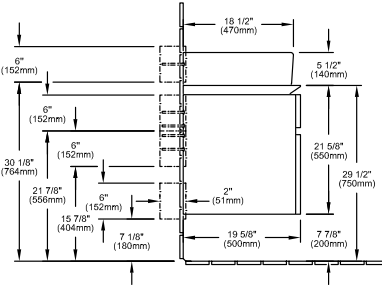
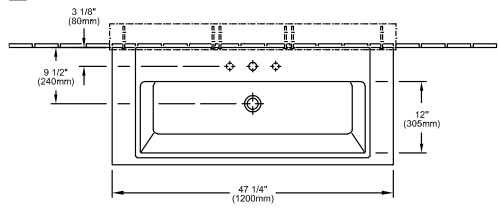

- + Indicate location for inwall support bracket
- + Dimensions taken from finished floor level
- + Sink not included
- Wall mounting

	A	1⌀
B149 U0 XX - 5133 U3	39 3/8" 1000mm	X
B149 U0 XX - 5133 UJ	39 3/8" 1000mm	
B149 U0 XX - 5133 U5	31 1/2" 800mm	X
B149 U0 XX - 5133 UL	31 1/2" 800mm	