

WASHBASINS, HANDWASHBASIN (BASIN ONLY), HAND WASHBASINS MEMENTO

PRODUCT INFORMATION

1 . POSITION



Model	5333U1
Width	15 3/4" inch
Depth	10 1/4" inch
Weight	18,52 lbs
Description	<p>Ground contact surface Sanitary porcelain for installation on countertop incl. cut-out template, incl. fastening set for installation to the wall EN 31, EN 14688 This vessel sink is made of vitreous china. The vessel sink is 15 3/4" x 10 1/4". The product is without overflow. The product is with ceramic plus. The vessel sink is Villeroy & Boch model 5333U1. meets and exceeds ASME A112.19.2/CSA B45.1 ASME A112.19.14, Code Compliance: UPC, IPC, NSPC, NPC Canada and others centered drain one year limited warranty waste diameter: 1 1/4" O.D. basin dimensions: 11" x 8 5/8" (280 x 220mm)</p>
Tap fitting / Tap hole remark	For single hole faucet only
Overflow remark	without overflow, Please note: unclosable grid drain must be used with models without overflow
Material	Sanitary porcelain
Specification texts	<p>; Handwashbasin (Ground); Sanitary porcelain; Size: 15 3/4" x 10 1/4" (400 x 260 mm); Rectangle; Ground contact surface; For single hole faucet only ; without overflow; Please note: unclosable grid drain must be used with models without overflow; for installation on countertop; incl. cut-out template, incl. fastening set for installation to the wall; EN 31, EN 14688; This vessel sink is made of vitreous china. The vessel sink is 15 3/4" x 10 1/4". The product is without overflow. The product is with ceramic plus. The vessel sink is Villeroy & Boch model 5333U1.; meets and exceeds ASME A112.19.2/CSA B45.1 ASME A112.19.14, Code Compliance: UPC, IPC, NSPC, NPC Canada and others; centered drain; one year limited warranty; waste diameter: 1 1/4" O.D.; basin dimensions: 11" x 8 5/8" (280 x 220mm)</p>

COLOURS

White Alpin	5333U101	4051202169183
White Alpin CeramicPlus	5333U1R1	4051202169176

TECHNICAL DRAWINGS

5333U1

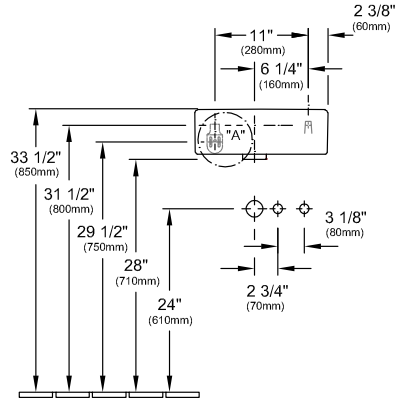
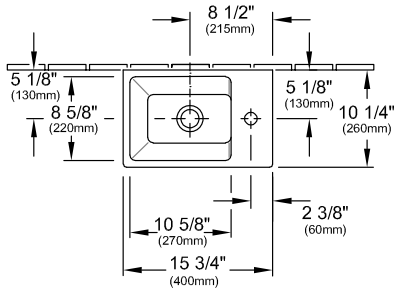

Detail "A"

